

We get retail.

Kemah Marketplace
Kemah, TX
153 Deke Slayton Hwy



WEINER DEVELOPMENT

We get retail.

180' H. L. & P. CO. R.O.W.

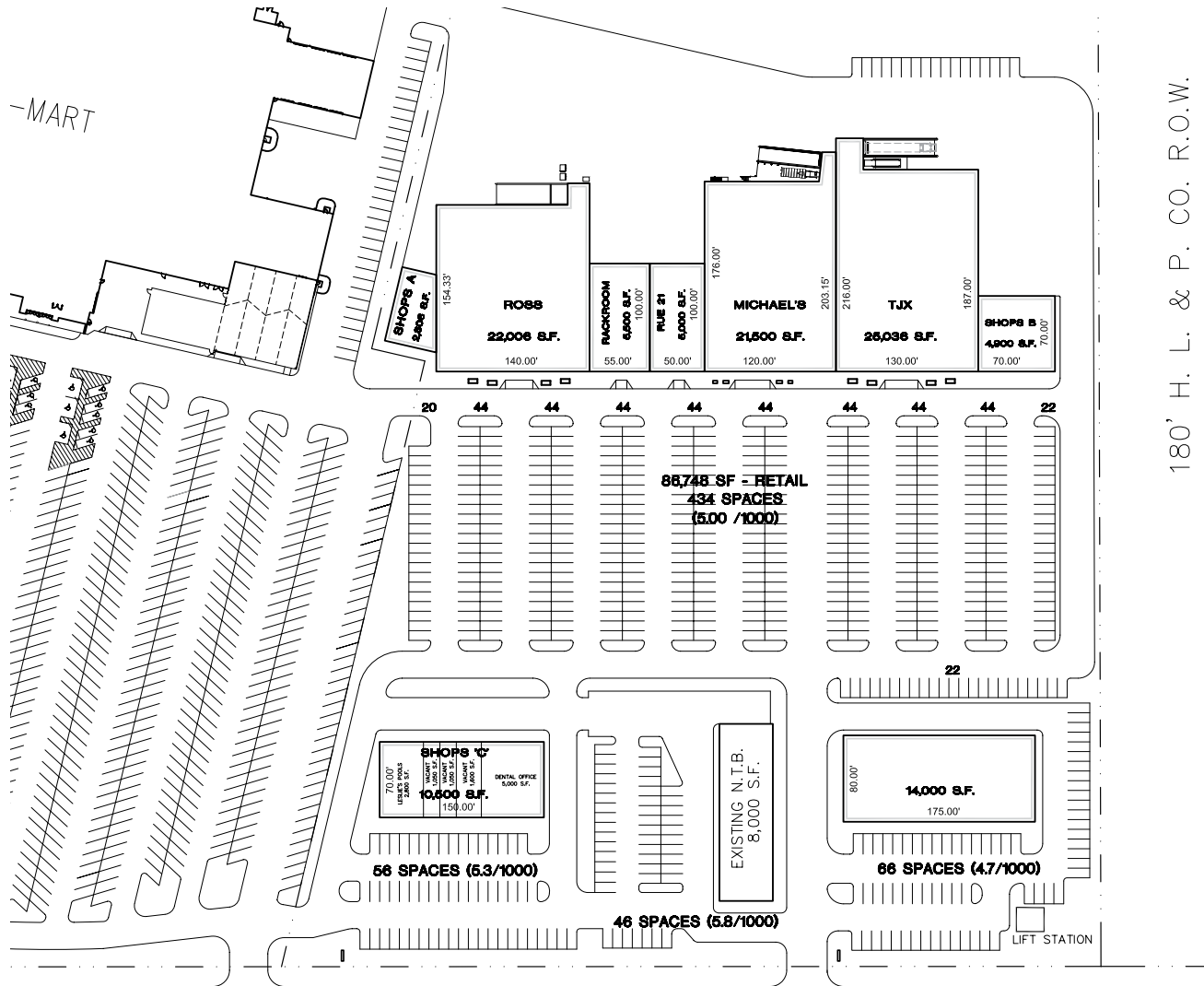

STATE F.M. HIGHWAY 518
(120' R.O.W.)

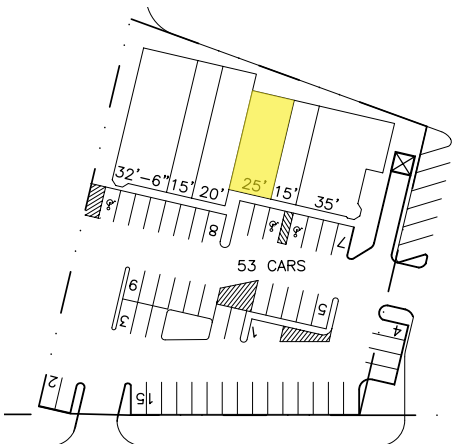

Pop-Facts: Census Demographic Quick Facts 2010 Report

Radius 1: FM 518 RD AT HIGHWAY 146, KEMAH, TX 77565, aggregate

Radius 2: FM 518 RD AT HIGHWAY 146, KEMAH, TX 77565, aggregate

Radius 3: FM 518 RD AT HIGHWAY 146, KEMAH, TX 77565, aggregate

Description	0.00 - 3.00 miles Radius 1		0.00 - 5.00 miles Radius 2		0.00 - 7.00 miles Radius 3	
		%		%		%
Population						
2000 Census	33,755		67,752		126,156	
1990 Census	22,093		49,125		99,331	
Growth 1990 - 2000	52.79%		37.92%		27.01%	
Household						
2000 Census	13,216		26,638		49,835	
1990 Census	8,842		19,568		39,467	
Growth 1990 - 2000	49.47%		36.13%		26.27%	
2000 Est. Population by Single Classification Race						
White Alone	29,450	87.25	57,626	85.05	101,791	80.69
Black or African American Alone	1,002	2.97	2,455	3.62	6,762	5.36
American Indian and Alaska Native Alone	162	0.48	318	0.47	605	0.48
Asian Alone	1,050	3.11	1,904	2.81	5,375	4.26
Native Hawaiian and Other Pacific Islander Alone	7	0.02	37	0.05	80	0.06
Some Other Race Alone	1,469	4.35	4,057	5.99	8,584	6.80
Two or More Races	615	1.82	1,354	2.00	2,958	2.34
2000 Est. Population Hispanic or Latino						
Hispanic or Latino	4,213	12.48	9,772	14.42	19,646	15.57
Not Hispanic or Latino	29,542	87.52	57,980	85.58	106,510	84.43
2000 Tenure of Occupied Housing Units						
Owner Occupied	8,713	65.93	17,588	66.03	31,066	62.34
Renter Occupied	4,503	34.07	9,050	33.97	18,769	37.66
2000 Average Household Size						
	2.55		2.53		2.51	

Pop-Facts: Census Demographic Quick Facts 2010 Report

Radius 1: FM 518 RD AT HIGHWAY 146, KEMAH, TX 77565, aggregate

Radius 2: FM 518 RD AT HIGHWAY 146, KEMAH, TX 77565, aggregate

Radius 3: FM 518 RD AT HIGHWAY 146, KEMAH, TX 77565, aggregate

Description	0.00 - 3.00 miles		0.00 - 5.00 miles		0.00 - 7.00 miles	
	Radius 1	%	Radius 2	%	Radius 3	%
2000 Est. Households by Household Income	13,216		26,638		49,835	
Income Less than \$15,000	924	6.99	2,281	8.56	4,843	9.72
Income \$15,000 - \$24,999	966	7.31	2,125	7.98	4,480	8.99
Income \$25,000 - \$34,999	1,358	10.28	2,779	10.43	5,549	11.13
Income \$35,000 - \$49,999	1,898	14.36	4,044	15.18	7,705	15.46
Income \$50,000 - \$74,999	2,752	20.82	5,520	20.72	10,509	21.09
Income \$75,000 - \$99,999	2,148	16.25	4,115	15.45	7,035	14.12
Income \$100,000 - \$149,999	2,211	16.73	4,030	15.13	6,676	13.40
Income \$150,000 - \$249,999	719	5.44	1,329	4.99	2,293	4.60
Income \$250,000 - \$499,999	172	1.30	340	1.28	534	1.07
Income \$500,000 and over	53	0.40	102	0.38	135	0.27
2000 Est. Average Household Income	\$74,278		\$72,096		\$67,574	
2000 Est. Median Household Income	\$63,213		\$59,527		\$55,478	
2000 Est. Per Capita Income	\$29,441		\$28,599		\$26,879	